



**INVENT BIO-MED Pvt. Ltd.**  
 Invention Enhances Life...  
 An ISO 9001-2008, ISO 13485-2003 Certified Company



# ScrewType

## HEMOSTASIS Y- CONNECTOR

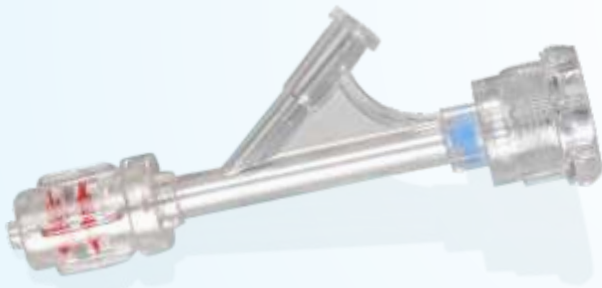

### Y Connector

- Accommodates virtually all Interventional Devices.
- Large Thumb Wheel for easy manoeuvrability.
- Rotating Swivel Luer Connector

### Ordering Information

Cat Code	Lumen	I.D
110301	9F (0.118")	3.0 mm



### Insertion Tool/Blunt Introducer

- Facilitate guidewire entry Smoothly.
- Fits guidewire sizes up to 0.020 inches.

Cat Code	O.D	I.D
111401	20 G (0.030")(0.90mm)	(0.020") (0.065 mm)

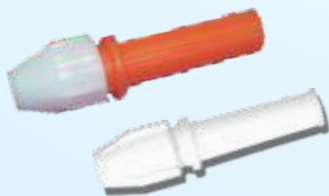

### Torquer

- Torquer device tightly holds all guidewire upto 0.020 inches in diameter.

Cat Code	GW Capacity
110401	Up to 0.020"

Cat Code	Description
110901	Kit: Hemostasis Y- Connector + Blunt Introducer + Torquer (P/W)

**Invent Bio-med Pvt. Ltd. (Head Office)**  
 517, Laxmi Plaza, New Link Road, Andheri (W)  
 Mumbai - 400 053 INDIA.  
**Tel.:** +91-22- 2632- 4234 **Fax:** +91-22- 2632- 4250  
**Email:** sales@inventbio-med.com  
[www.inventbio-med.com](http://www.inventbio-med.com)